

1	2	3	4	
RevNo	Revision note	Date	Signature	Checked
00	Sketch Only	7/8/14	Teresa	Simon

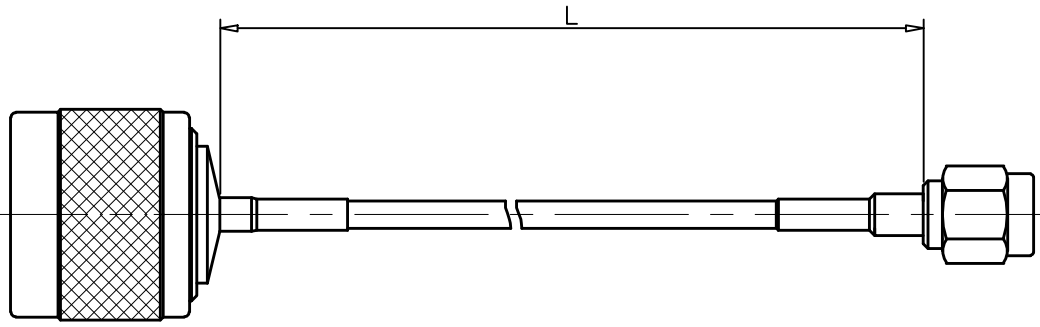

Interface of N connector Per: MIL-C-39012, IEC 60169-16
 Interface of SMA connector Per: MIL-STD-348, IEC 60169-15
 Material & Finishing:

- N:
- Center conductor: Phosphor Bronze, Gold Plating
 - Insulators: PTFE
 - Body & Other Metal: Brass, Nickel Plating
 - Gasket: Silicone Ribber

- SMA:
- Center conductor: Brass Copper, Gold Plating
 - Insulators: PTFE
 - Spring Washer: Beryllium Copper
 - Body : Brass, Gold Plating
 - Coumping Nut: Brass, Gold

- Cable:
- Center Conductor: Silver Plated Copper Clad Steel
 - Insulator: PTFE
 - Outer Conductor: Tin Soaked Copper Braid
- Heat Shrink Tube: Polyolefine

- Electrical Data:
- Impedance: 50 Ohms
 - Frequency Range: DC to 6.0 GHz
 - Insulation Resistance: 1000 Megohms
 - Dielectric Withstanding Voltage: 750 V Min.
 - VSWR: ≤ 1.25
 - Insertion Loss: $\leq 1.8\text{dB}/\text{M} + 0.2\text{dB}$

ALL DIMENSIONS ARE IN MILLIMETERS AND [INCHES]

KERUI ELECTRONIC CO;LTD

Title
 N male to SMA male
 solder with .085 semi-rigid cable

THESE DRAWING & SPEC. ARE THE PROPERTY OF KERUI ELECTRONIC CO;LTD AND SHALL NOT BE REPRODUCED, OR COPIED OR USED AS THE BASIS FOR THE MANUFACTURE OR SALE OF APPARATUS OR DEVICES WITHOUT THEIR EXPRESS WRITTEN CONSENT.

UNLESS OTHERWISE NOTED ALL SURFACES FINISHED TO 64/MAX.
 ALL TOLERANCES ARE:
 DECIMALS FRACTIONS ANGLES
 $x \pm 1.0$ $\pm 1/64$ $x' \pm 1'$
 $x.x \pm 0.5$ $x'x' \pm 0.5'$
 $x.xx \pm 0.1$

Drawn by Teresa	Ckd by Simon	Appd by Richard	Date 7/8/2014
Scale 1.5:1	Sheet 1 of 1	C802101 29 33 01	